

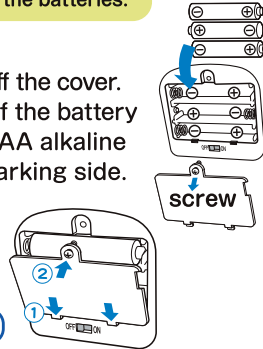

### How to replace batteries LR03("AAA"SIZE)BATTERY

When Olaf's voice is small or does not react please change the batteries.

- The battery cover is on the back of the main unit.  
Loosen the screw with a screw driver and take off the cover. Make sure you set the + and - polarity marking of the battery in the correct direction when replacing the 3 AAA alkaline batteries. Set the battery from the - polarity marking side.
- Slide in the 2 parts of the cover in ①.  
Close ② in the direction of the arrow and tighten the screw with a screw driver.



Do not use old and new batteries or different batteries together.

### To play

- Open the back and slide the switch to on !  
Olaf will let you know when the power is on !  
(Please slide the switch to off when you finish playing.)

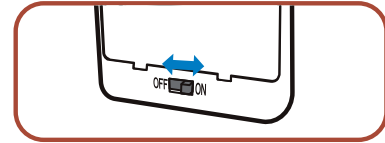

- Talk to Olaf ! Olaf talks as he walks when he hears voices and other sounds !

## Olaf walks and talks when he hears sound!!



### When the power is on

Olaf will let you know when the power is on!

① Hi how's it going?

### When he walks

② I was built out of Elsa's love for her sister.

③ Oh, yeah. Water has memory.  
It's my favorite of the unproven theories.

④ I like to consider myself a bit of a shape shifter.

⑤ Hmm? Did you feel the breeze?  
Isn't it delicious.

⑥ Do you wanna hold my hand?

### When not playing for 30 seconds

Olaf will let you know by talking.

⑦ That tickles.



## 电池说明

3节 1.5V(AAA) 碱性电池

假如有音乐走调，或者是布偶反应变差的情况发生，请更换电池

- 1 电池盖在主体后方。扭松螺丝并取走电池盖，再装上三节 AAA 碱性电池。安装电池时，请先把电池的 - 极安在电池盒内并确保电池安装在正确的极向 (±)。

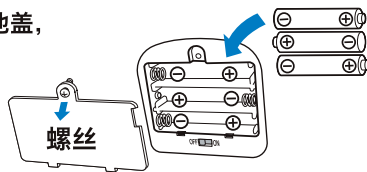

- 2 把电池盖的凸槽沿①方向推进固定口中。把电池盖往②的方向推并用螺丝刀把螺丝收紧。

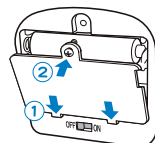

不同类型的电池或新旧电池不能混用

## 游玩方法

- 1 打开背部并把开关拨向 "ON" 方向。尝试对着布偶说话吧！游玩过后，请关掉电源 (OFF)。

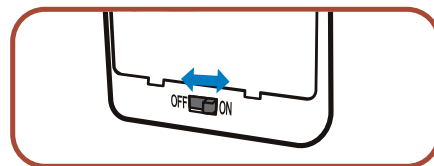

- 2 听到声音后，布偶会边说话边行走啊！

## 听到声音后，雪宝会边说话边行走啊！

### 当开启电源时

雪宝会告诉您电源已开启

- ① Hi how's it going?

### 当他步行时

② I was built out of Elsa's love for her sister.

③ Oh, yeah. Water has memory.  
It's my favorite of the unproven theories.

④ I like to consider myself a bit of a shape shifter.

⑤ Hmm? Did you feel the breeze?  
Isn't it delicious.

⑥ Do you wanna hold my hand?

### 当闲置30秒时

雪宝会告诉您被闲置

- ⑦ That tickles.

合共7种  
句子



## 電池說明

3 顆 1.5V(AAA) 鹼性電池

假如有音樂走調，或者是佈偶反應變差的情況發生，請更換電池

- 1** 電池蓋在本體的後方。扭鬆螺絲並取走電池蓋，再裝上三顆 AAA 鹼性電池。安裝電池時，請先把電池的 - 極裝入電池盒內並確保電池極向正確 (+/-)。

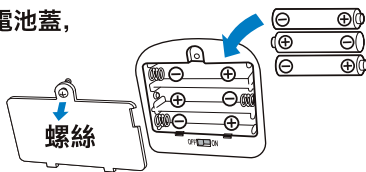

- 2** 把電池蓋的凸槽沿①方向推進固定口中。把電池蓋推向②的方向並用螺絲刀把螺絲收緊。

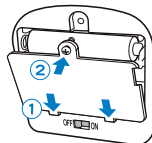

不同類型的電池或新舊電池不能混用

## 遊玩方法

- 1** 打開背部並把開關撥向 "ON" 方向。嘗試對著佈偶說話吧！遊玩過後，請關掉電源 (OFF)。

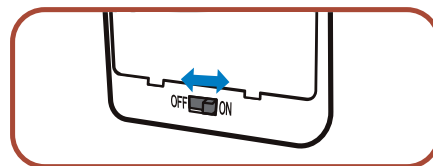

- 2** 聽到聲音後，佈偶會邊說話邊行走啊！

## 聽到聲音後，雪寶會邊說話邊行走啊！

### 當開啓電源時

雪寶會告訴您電源已開啓

- ① Hi how's it going?

### 當他步行時

② I was built out of Elsa's love for her sister.

③ Oh, yeah. Water has memory.  
It's my favorite of the unproven theories.

④ I like to consider myself a bit of a shape shifter.

⑤ Hmm? Did you feel the breeze?  
Isn't it delicious.

⑥ Do you wanna hold my hand?

### 閒置 30 秒時

雪寶會告訴您被閒置

- ⑦ That tickles.

合共 7 種  
句子



### 건전지 교환 방법

#### AAA형 알칼리 건전지

재생되는 목소리 속도가 느려지거나 같은 단어를 반복하는 현상이 일어나면 건전지를 교환해주세요.

**1** 본체 뒷면의 전지 덮개의 나사를 드라이버로 풀어 건전지 덮개를 엽니다. 다 된 건전지를 빼고, 새 AAA형 알칼리 건전지 3개를 +, - 방향에 맞게 세팅하여 주세요. 건전지는 -(마이너스) 방향부터 넣어 주시기 바랍니다.

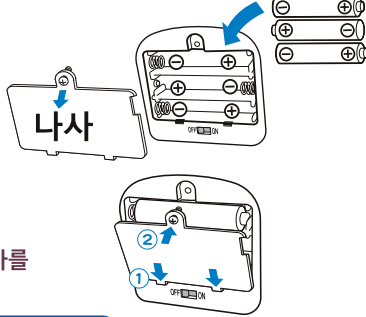

**2** ①의 화살표 부분을 아래부터 꺾은 후 ②를 화살표 방향으로 끼워, 드라이버로 나사를 고정시켜 주세요.

오래된 건전지와 새 건전지, 여러 종류의 건전지를 혼합하여 사용하지 말아 주세요.

### 놀이 방법

**1** 등을 열어 스위치를 켜 주세요!  
올라프가 목소리로 스위치를 ON으로 바꾸어 달라고 알려줘요! (놀이가 끝난 뒤에는 스위치를 OFF로 해 주세요.)

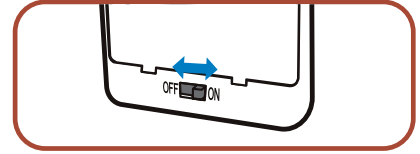

**2** 올라프를 향해 말을 걸어주세요!  
목소리나 소리가 들리면 올라프가 말을 하며 걷기 시작해요!

# 소리가 들리면 올라프가 걸어가며 말을 해요!!

## 전원이 ON 상태일 때

올라프는 전원이 ON 상태일 때 당신에게 알려줍니다!

① Hi how's it going?

## 올라프가 걸어갈 때

② I was built out of Elsa's love for her sister.

③ Oh, yeah. Water has memory.  
It's my favorite of the unproven theories.

④ I like to consider myself a bit of a shape shifter.

⑤ Hmm? Did you feel the breeze?  
Isn't it delicious.

⑥ Do you wanna hold my hand?

## 30초 간 아무 반응이 없을 때

올라프가 말을 걸어 당신에게 알려줍니다.

⑦ That tickles.

말하는 모드는  
전부 7종류  
영어로 말해요!